

**CC-2-1
CURING TUNNEL**

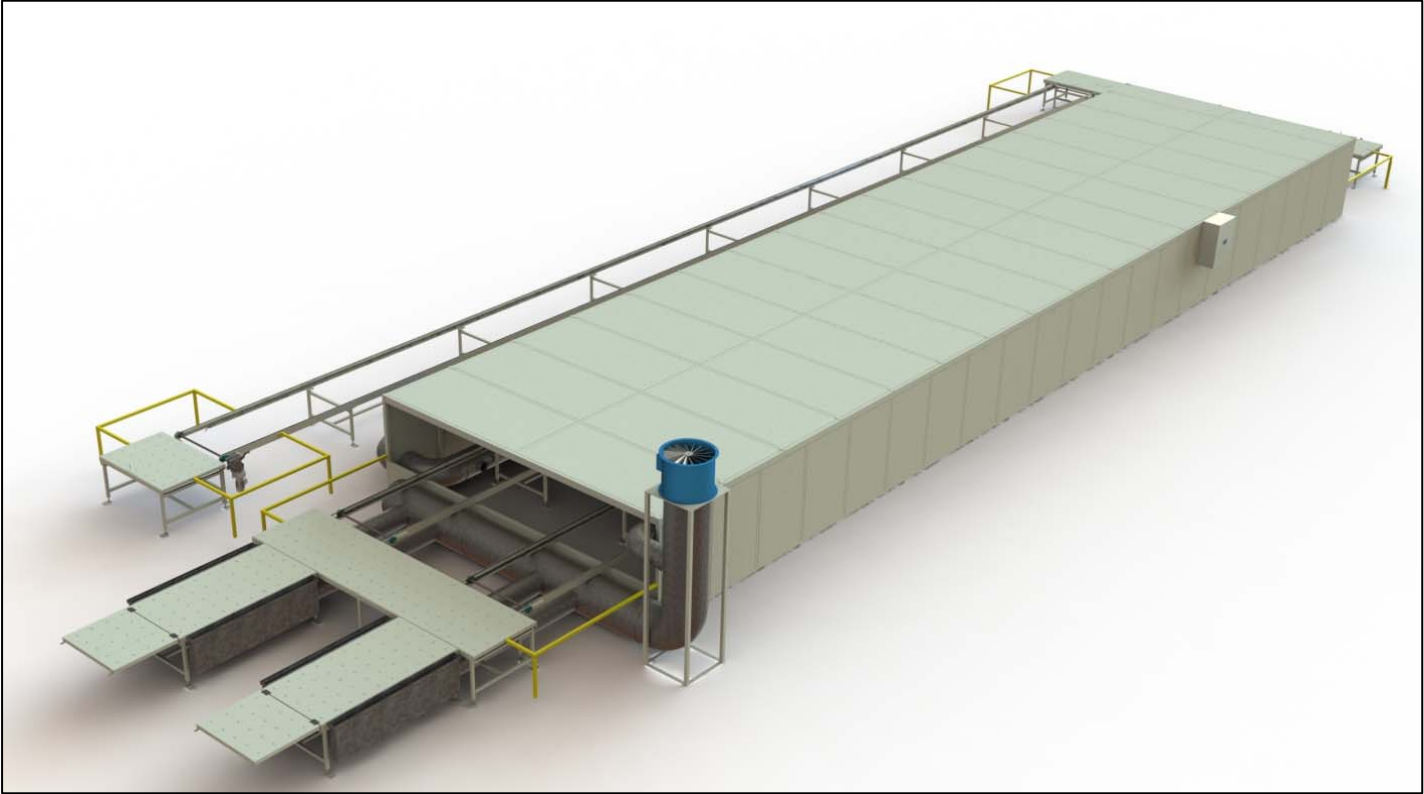

MACHINE SPECIFICATION

ELEMENT	SPECIFICATION
Machine Capabilities	Maximum product size: 2000mm x 1400mm Number of conveyors: 2 Maximum output: 25 products per hour
Machine Construction	Enclosure: Sheet steel – BS EN 10025 material Double skin insulated Size: Width 6.5m – Depth 22m – Height 1.7m
Conveyors	Width: 1200mm Mechanism: Chain driven Curing track speed: 0.3m/min Returns track speed: 0.6m/min
Load / unload	Roller entry/exit tables for easy handling of products.

Heating	Remotely sited gas fired warm air heating (specification dependent on location) Low level extraction.
Control System	Automatic start/stop of conveyors - PLC controlled using electrical sensors. Electronic temperature controller. Inverter control for conveyor speed adjustment. Normal service temperature: 40°C
Electricity	3 Phase supply + Neutral + Earth: 380/415V @ 50Hz Maximum power consumption: 10kW
<i>example specification only - specification may be subject to change without notice</i>	

For further information contact

Armour Plastics Limited
Engineering Division
Pattinson Industrial Estate
Washington, Tyne & Wear, NE38 8QH, England

Telephone: +44 (0)191 416 7786 Fax: +44 (0)191 416 7109

sales@armour-engineering.com
www.armour-engineering.com