

**HT-5-1
DOUBLE STATION HORIZONTAL
THERMOFORMER**

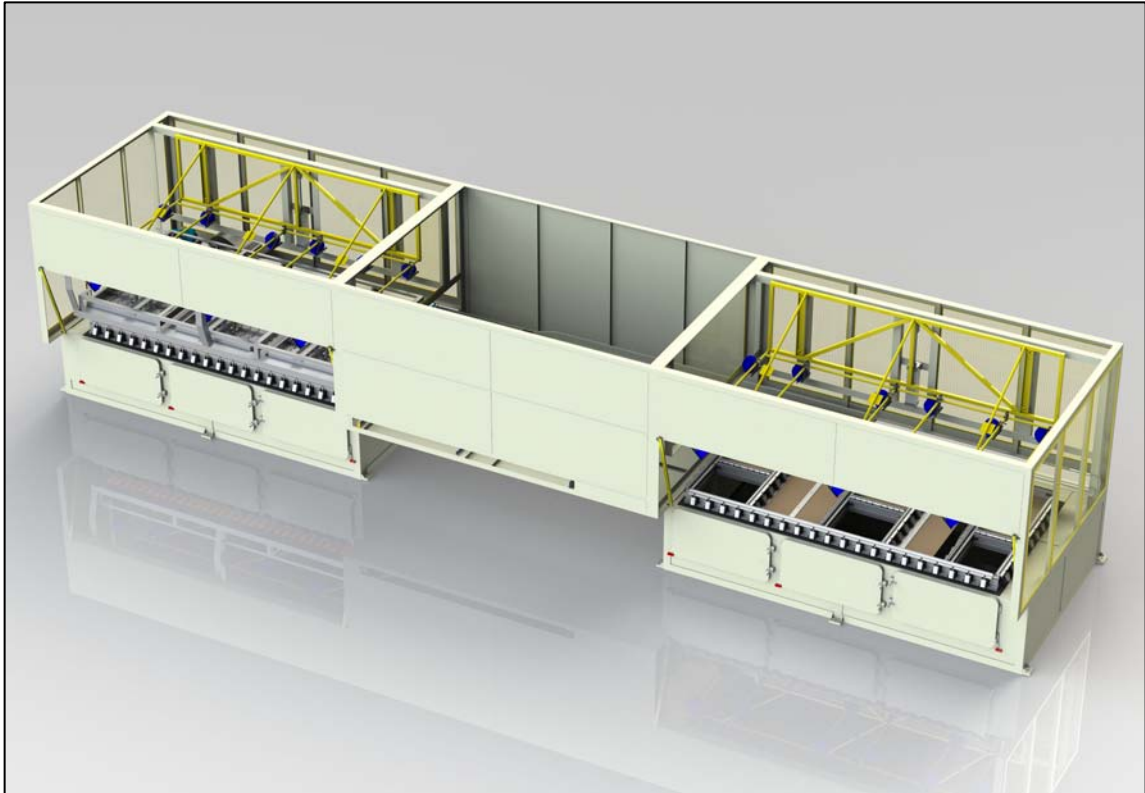

MACHINE SPECIFICATION

ELEMENT	SPECIFICATION	
Machine Capabilities	Number of moulding positions: Maximum forming aperture: Minimum forming aperture: Maximum tool height: Maximum tool push through: Cycles per hour (2mm Acrylic capped ABS): Products per hour:	6 (3 per station) 1810 x 1010mm 700 x 700mm 500mm 250mm 14 cycles 84
Machine Construction	Main frame: Casing: Paint finish:	Rolled steel sections – BS EN 10025 material Sheet steel – BS EN 10025 material Textured powder coating
Clamping Bars	Material: Adjustment:	Extruded aluminium profile – Armour design By precision linear slides & make up pieces

Heating System	<p>Top bank of quartz infra-red heating elements</p> <p>Element size: 112 x 112mm</p> <p>Element power: 450W</p> <p>Total elements per heater bank: 144 per bank (3 banks, 1 per moulding position)</p> <p>Element distribution: 9 wide x 16 deep per bank</p> <p>Number of heating zones: 72 per bank (each containing 2 top elements)</p> <p>Zone control: Software controlled</p> <p>Power: 0 – 100% in 1% increments</p>
Mould Table Movement	By hydraulic power through mechanical gearing
Vacuum System	<p>Vacuum pump motor rating (when supplied): 5.5kW</p> <p>Vacuum pump flow rate: 250m³/hr</p> <p>Programmable double vacuum facility</p>
Product cooling	<p>By cooling fans with directional adjustment</p> <p>Number of fans: 4 per moulding position 24 total</p> <p>Flow rate per fan: 6020m³/hr</p>
Mould Heating Facility	<p>Power rating (when supplied): 9kW</p> <p>On/Off timer from control system</p>
Safety	Forming stations light guard protected
Control System	<p>Mitsubishi PLC controlled sequence.</p> <p>Touch screen user interface.</p> <p>Ethernet connection for remote diagnostic interrogation.</p>
Compressed Air	<p>Minimum pressure: 5.5 Bar</p> <p>Dry filtered supply</p>
Electricity	3 Phase supply + Neutral + Earth: 380/415V @ 50Hz

For further information contact

Armour Plastics Limited

Engineering Division
Pattinson Industrial Estate
Washington, Tyne & Wear, NE38 8QH, England

Telephone: +44 (0)191 416 7786 Fax: +44 (0)191 416 7109

sales@armour-engineering.com
www.armour-engineering.com